



MAYOR PRO TEM
DAVE
MARTIN

Welcome to Mayor Pro Tem Martin's Farewell Town Hall Series

**Housekeeping Note: All presentations will be completed
first followed by questions at the end of the program.**

Special Presentation by:



**Mark Wilfalk, Director
City of Houston
Solid Waste Management**





MICHAEL ERETI

DIRECTOR OF CAPITAL PROJECTS



PURPOSE

together we create a strong foundation for Houston to thrive

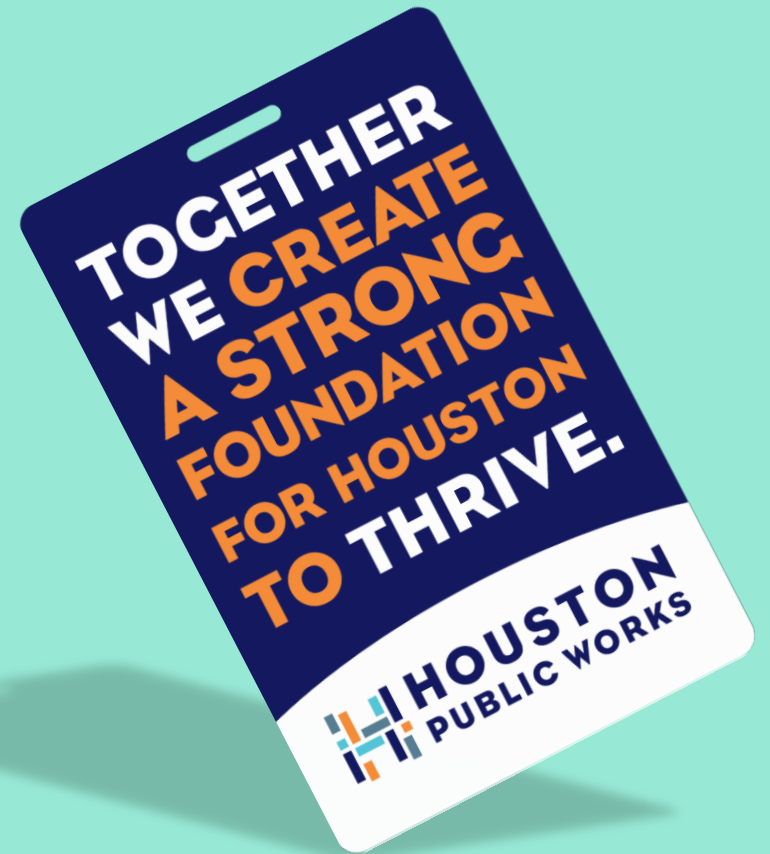

5 TO THRIVE VALUES

integrity | teamwork | ownership | communication | respect

CRENSHAW ROAD FROM SOUTH SHAVER STREET TO ALLEN GENOA ROAD RECONSTRUCTION

TYPE STREET

COST \$1 MILLION

START SUMMER 2023

COMPLETION FALL 2023





LOCATION

EL DORADO: CLEAR LAKE CITY BLVD. TO WOODBURNE DR.

TYPE PAVING

COST \$7.1 MILLION

START 2020

COMPLETED 2022

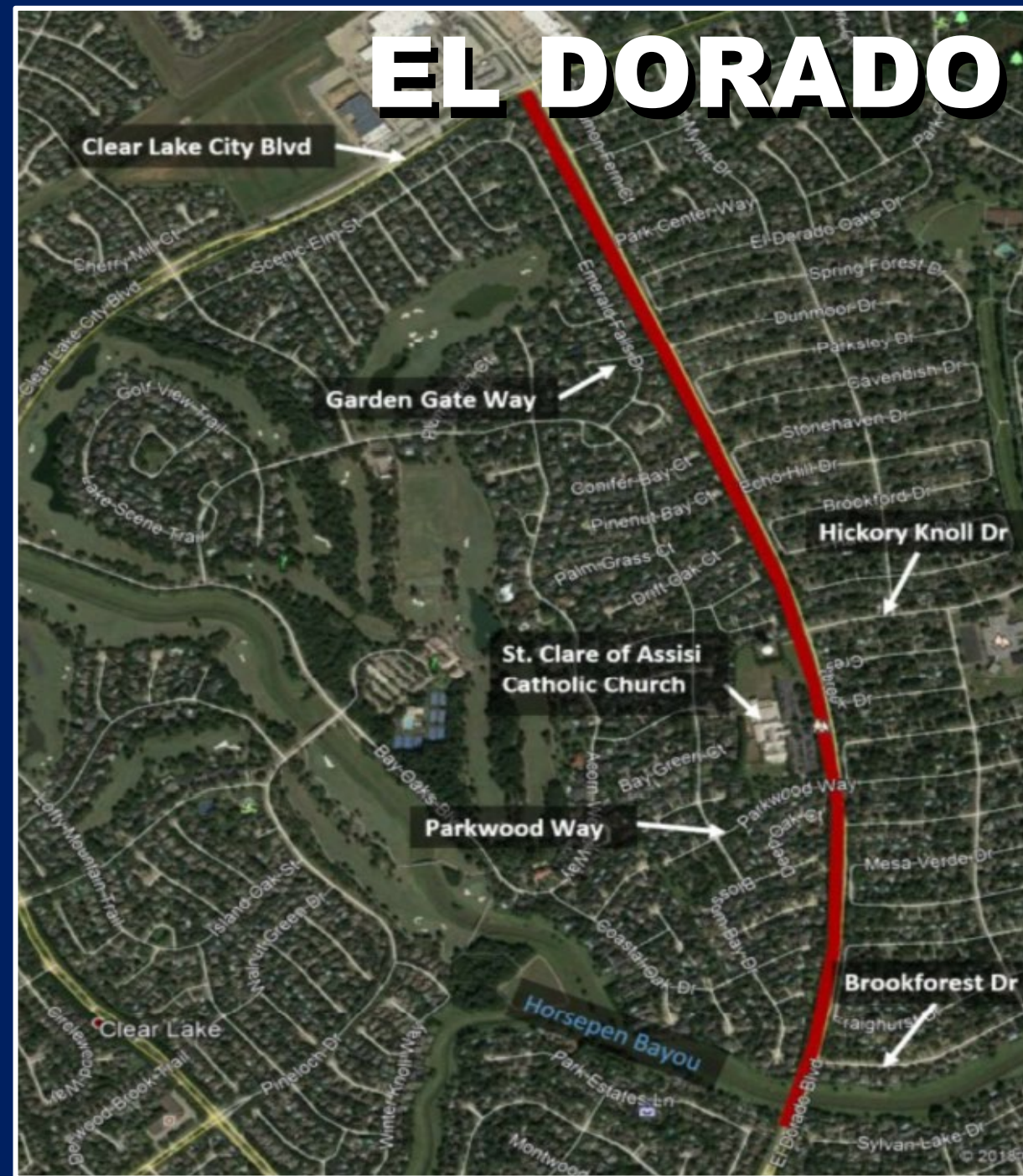



CRENSHAW STORMWATER DETENTION BASIN EXPANSION

TYPE DRAINAGE (HCFCD)

COST \$6.7 MILLION

EST. START SPRING 2022

EST. COMPLETION FALL 2023



ARLINGTON HEIGHTS AREA- SUBPROJECT 1

TYPE DRAINAGE

COST \$21 MILLION

EST. START WINTER 2024

EST. COMPLETION WINTER 2026

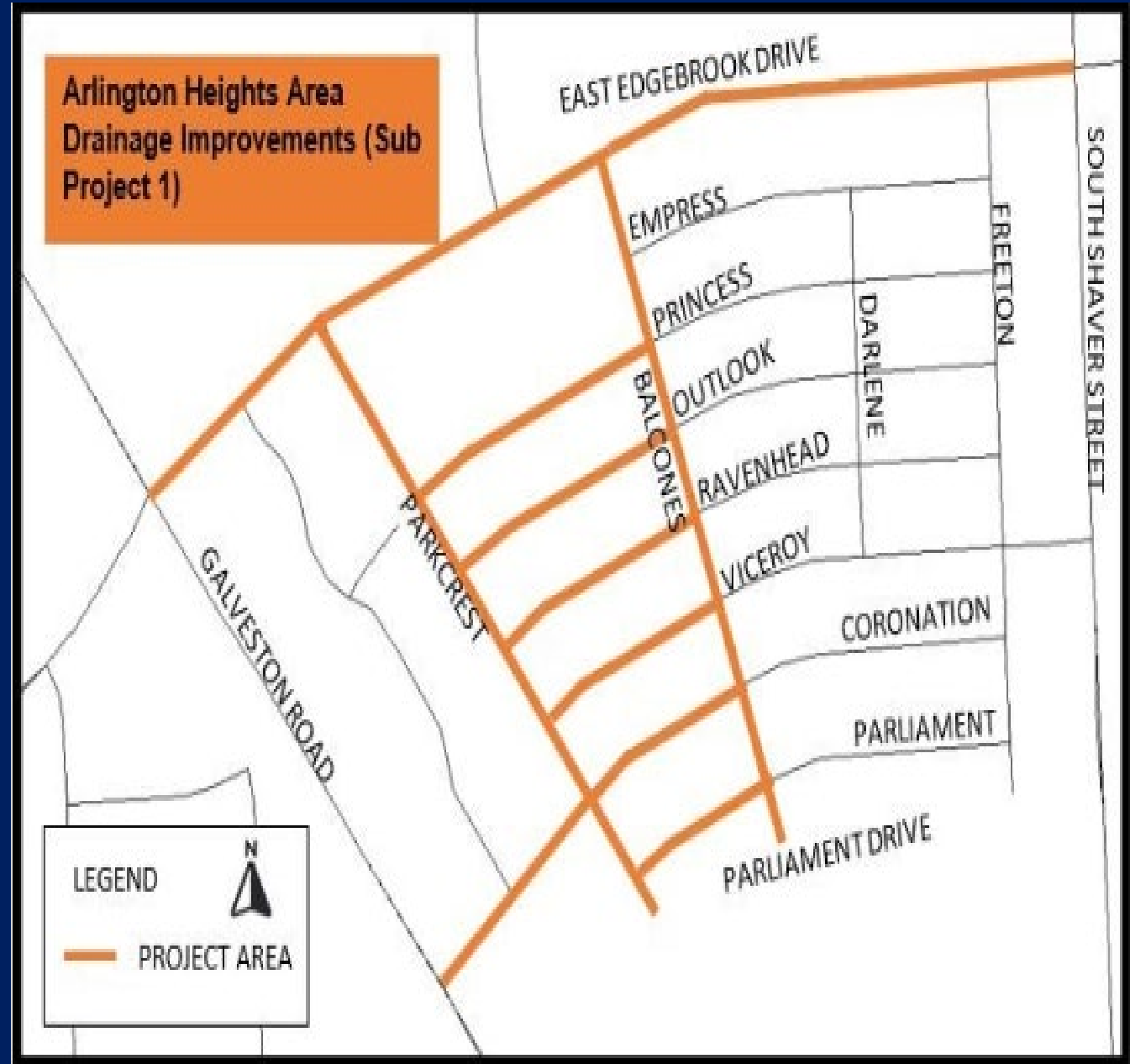

ARLINGTON HEIGHTS AREA- SUBPROJECT 2

TYPE DRAINAGE

COST \$13 MILLION

EST. START FALL 2025

EST. COMPLETION SPRING 2027

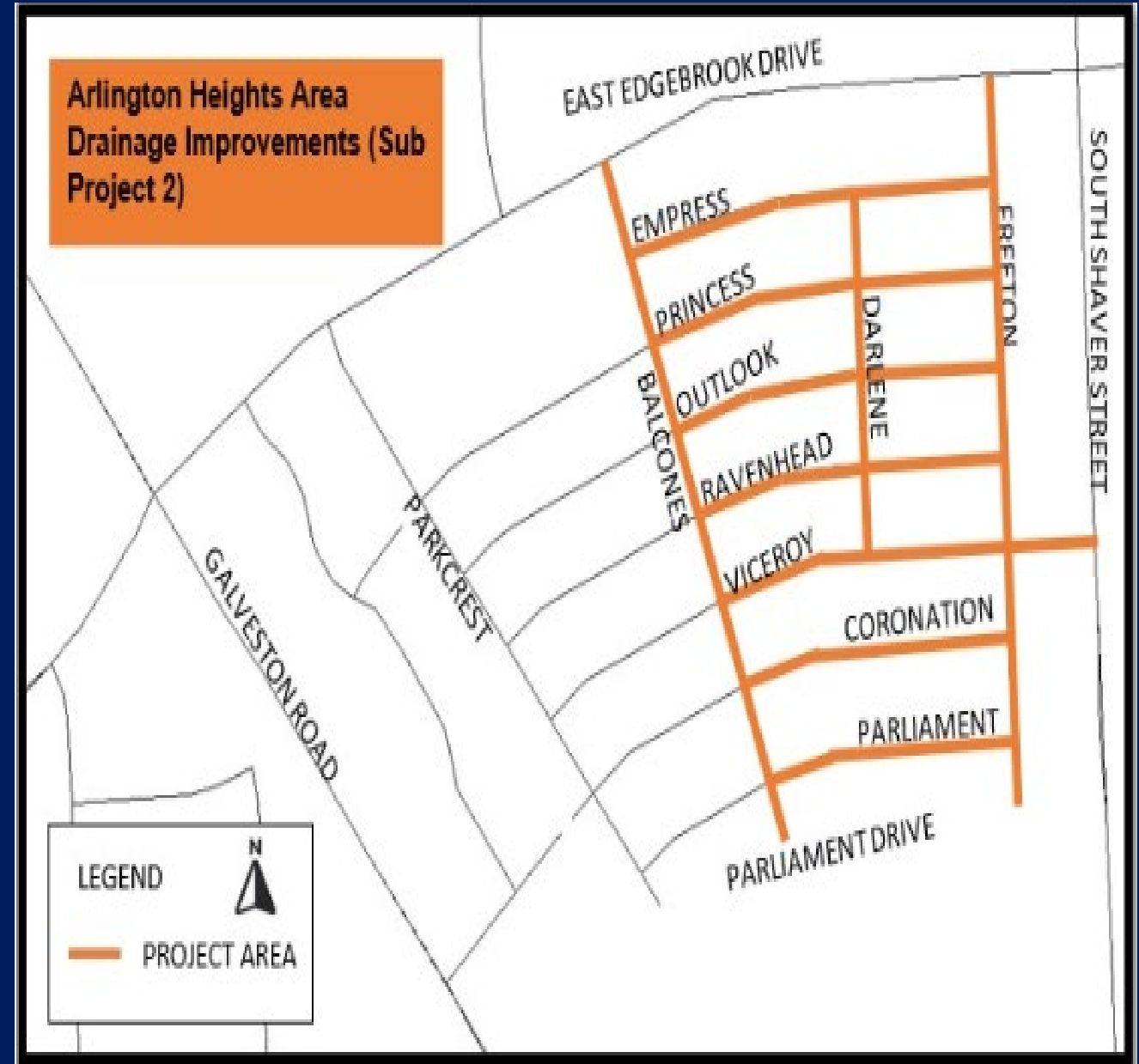

ENGAGEHOUSTON.ORG



THANK YOU!





Houston Police Department – Clear Lake Division
Crime Statistics Overview
Commander Claudia Cruz



**HOUSTON
SPACEPORT**



**Houston Spaceport Updates
Jimmy Spence, Marketing and
Business Development Specialist**

BUILDING HOUSTON SPACEPORT



**HOUSTON
SPACEPORT**





HOUSTON
SPACEPORT



A PROVEN FORMULA

ENTREPRENEURSHIP

\$5,000,000,000 USD of contracts for the companies at Spaceport Houston.

INNOVATION

1,800 new high-paying aerospace jobs in Houston.

DEVELOPMENT

More than 500,000 square feet of facilities have been built for the aerospace industry.

Since 2012, one of our strategic objectives has been to grow EFD from a small, regional GA airport into a hub for innovation and a Center for commerce and economic activity.

Our unique position and history led us to pursue growth in both the aviation and aerospace sector.

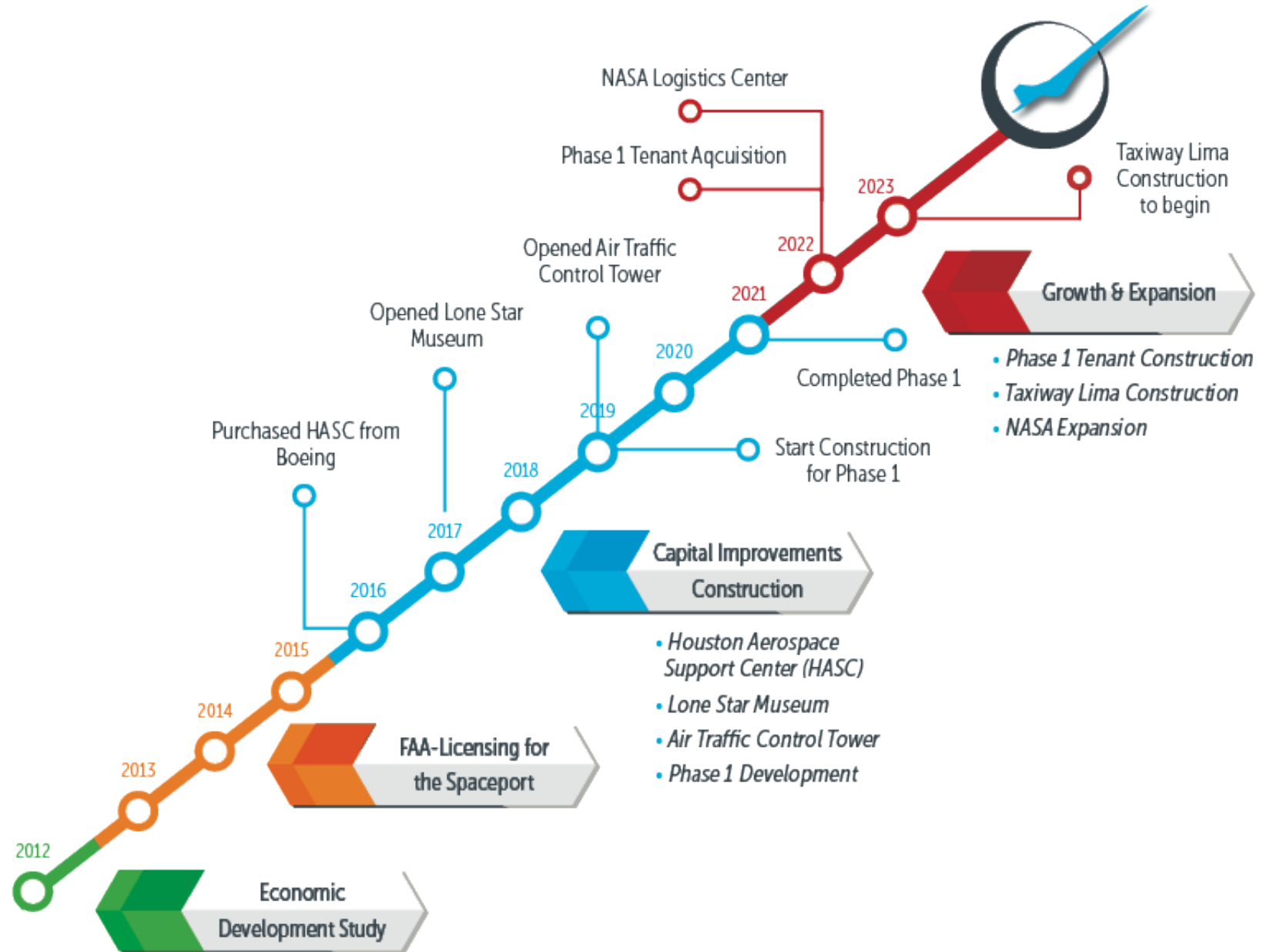

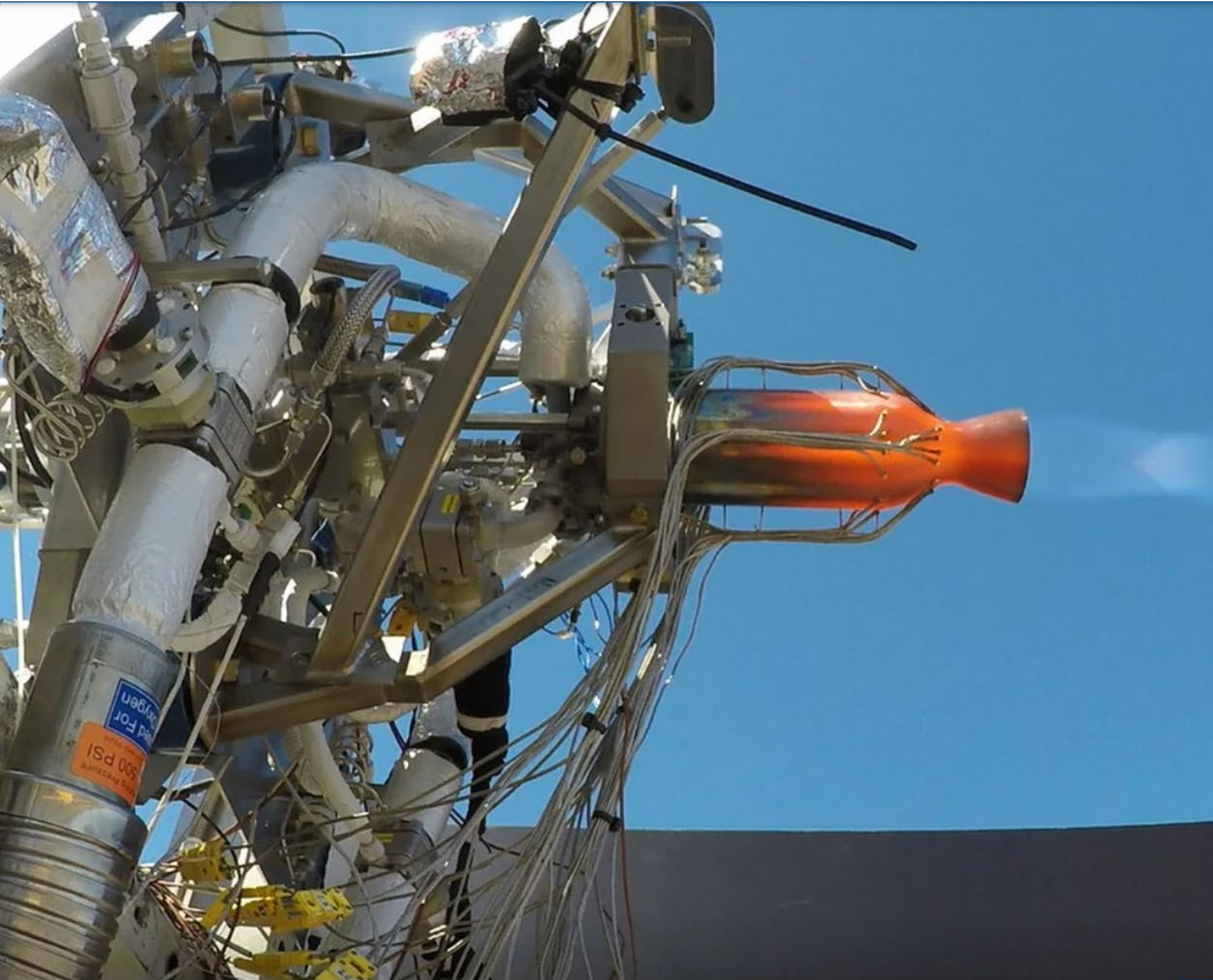

Our Approach:

- Create attractive opportunities for our members, through amenities and incentives.
- We identify and leverage our capabilities and infrastructure where possible.
- We encourage relationships with Economic Development groups, Universities, and Industry.

**In less than six years, we
moved from the
concept phase to
working on activities
that support low-Earth
orbit lunar and
planetary missions.**



**HOUSTON
SPACEPORT**



Training and education at the Spaceport, such as San Jacinto College's EDGE training center. This program partners with industry to offer students the best up-to-date knowledge about the aerospace industry.

The center incorporates classrooms, offices and laboratories within the Spaceport's Houston Aerospace Support Center.

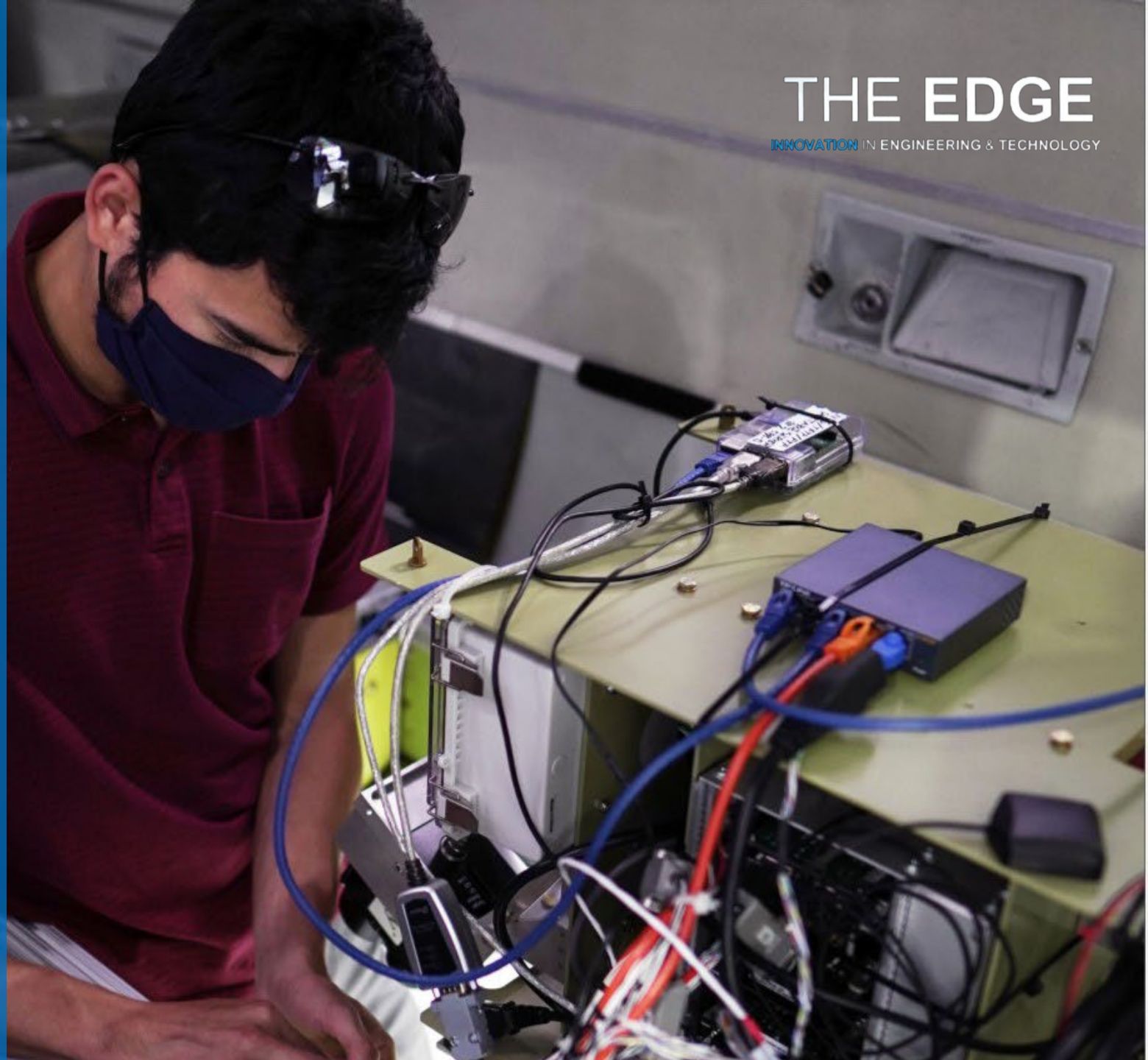

THE EDGE
INNOVATION IN ENGINEERING & TECHNOLOGY



3rd

Axiom Space, Inc
Address TBD
 Phase 1 -
 Construction Start March 2022
 End Date April 2023

 **Collins Aerospace**



Collins Aerospace
2555 Atlantis Shuttle St
Houston Tx 77034
 Construction Start August 2021
 End Date August 2022



2nd

Intuitive Machines
13467 Columbia Shuttle St
Houston Tx 77034
 SEVF Building (Phase 1)
 Construction Start Jan 2022
 End May 2022

Main facility (Phase 2)
 Construction start March 2022
 End May 2023



COLLINS AEROSPACE EXPANDS ITS PRESENCE IN HOUSTON AT THE SPACEPORT.

Collins Aerospace completed its new eight-acre, 120,000-square-foot campus to support human spaceflight, including the next generation of astronaut suits. It also includes a 10,000-square-foot incubation center for aerospace and aviation companies.



THE DEVELOPMENT OF THE COMMERCIAL SPACE STATION ALSO STARTS FROM THE HOUSTON SPACEPORT.

NASA selected Houston-based Axiom Space to design and build habitable modules for the new commercial space station.

Axiom Space was also selected by NASA to manufacture the next generation of astronaut suits.

The first phase of the Axiom facility includes 106,000 square feet and will be completed by the end of September 2023.

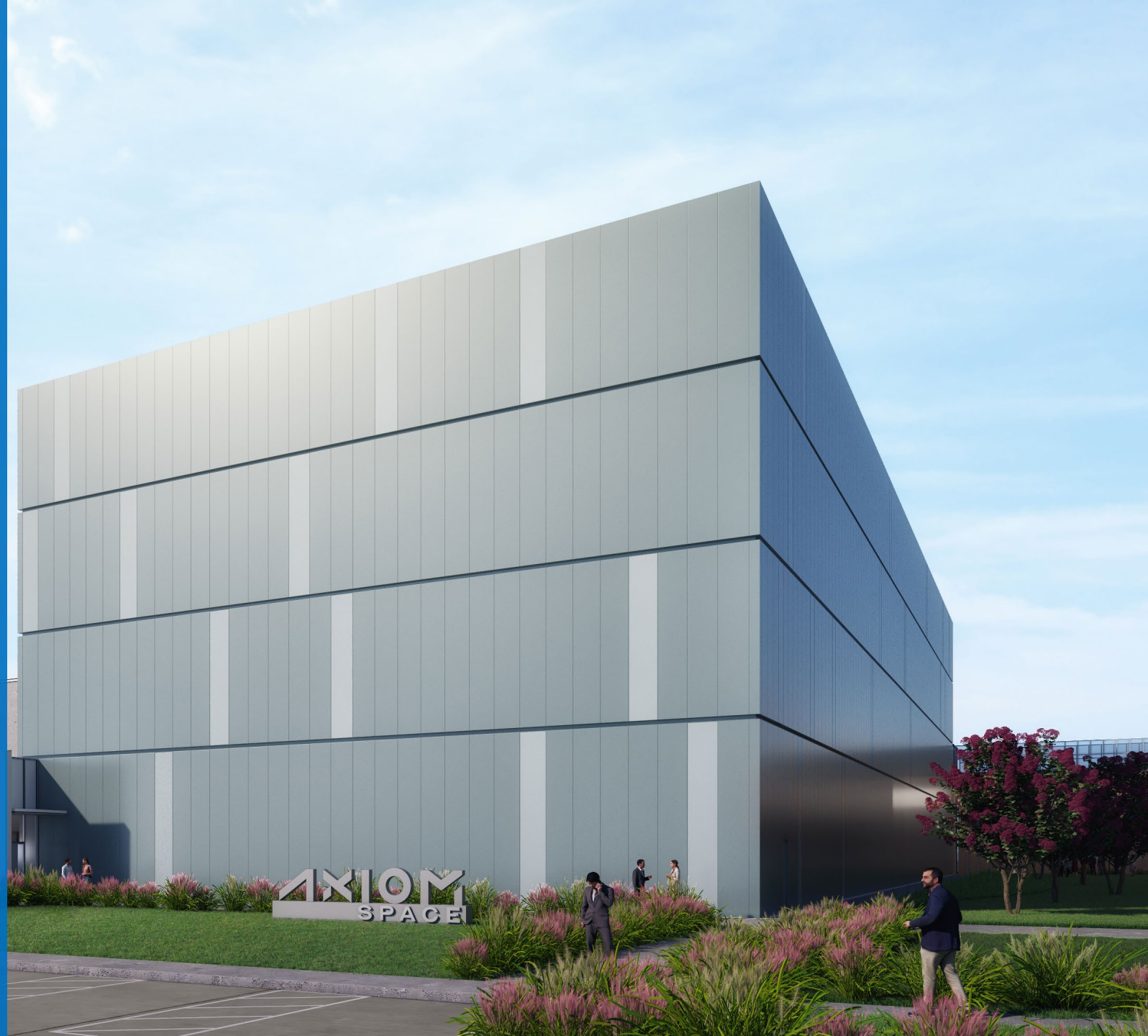

INTUITIVE MACHINES GROWS AT HOUSTON SPACEPORT

Intuitive Machines announced the construction of its new 125,000 square foot facility at the spaceport to house all their operations. IM began construction in December 2021. They will transition from their current location at HASC in September 2023.

IM began using its small engine verification building in September 2022 for integrated testing of its Nova-Clunar lander engine.



HYPERSONIC TECHNOLOGY ARRIVED AT THE HOUSTON SPACEPORT WITH VENUS AEROSPACE.

This startup is designing a hypersonic plane that will travel 9 times faster than the speed of sound and at an altitude of 150,000 feet, which is high enough to see the blackness of space.

Venus is currently in EFD's traditional area of operations and is growing rapidly.

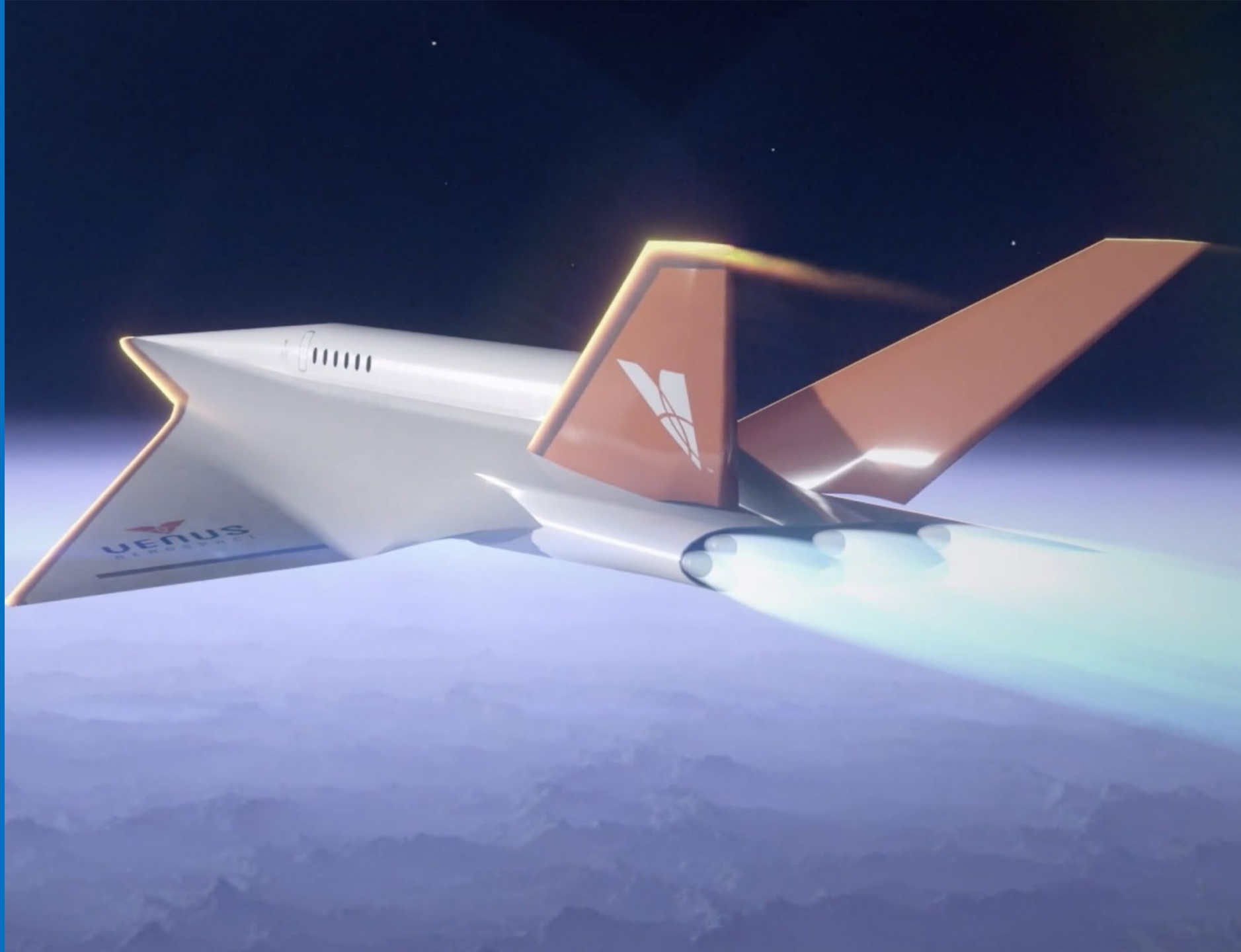



Houston Aerospace Institute

HAS has been working with our HS-CREW partners and FS Group architects to design a collaboration center in the first phase of the Spaceport.

The Aerospace Institute will serve as a hub where industry and academia can come together to collaborate on workforce development, research and career development.

DESIGN AND LAND USE

The Houston Airport System has been working with Jacobs and others to plan for the future of the Houston Spaceport. Our land use and design guide will map the entirety of the spaceport and sharpen our vision of what is to come.



**Thank you for
your time**



**HOUSTON
SPACEPORT**



QUESTION AND ANSWER

- Approach the floor microphone
- State your name and who your question is for
- You will have **TWO MINUTES**
- Please be respectful
- Residents are limited to one question at a time



THANK YOU FOR YOUR ATTENDANCE.

HAVE A SAFE DRIVE HOME!