

# CITY OF HOUSTON

## DEPARTMENT OF PUBLIC WORKS AND ENGINEERING ENGINEERING AND CONSTRUCTION DIVISION

### MEMORIAL DRIVE PAVING AND DRAINAGE IMPROVEMENTS PROJECT

FROM 200' WEST OF NORTH ELDRIDGE PARKWAY TO 600' EAST OF NORTH KIRKWOOD

WBS No.N-000798-0001-4

CSJ 0912-70-082

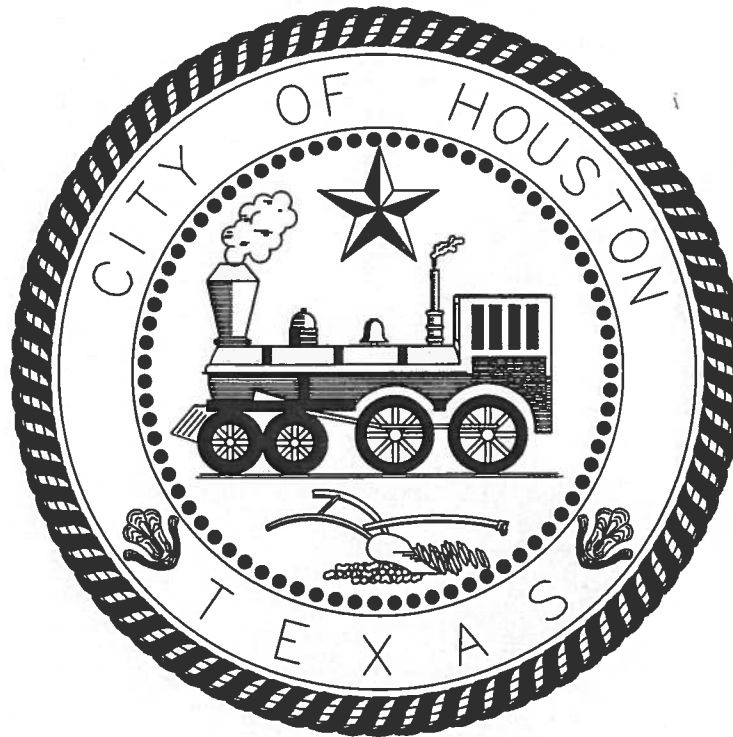

MAYOR  
ANNISE D. PARKER

CONTROLLER  
RONALD C. GREEN

#### DISTRICT COUNCIL MEMBERS

|                                 |                           |                               |
|---------------------------------|---------------------------|-------------------------------|
| BRENDA STARDIG<br>DISTRICT A    | JERRY DAVIS<br>DISTRICT B | ELLEN COHEN<br>DISTRICT C     |
| DWIGHT BOYKINS<br>DISTRICT D    | DAVE MARTIN<br>DISTRICT E | RICHARD NGUYEN<br>DISTRICT F  |
| OLIVER PENNINGTON<br>DISTRICT G | ED GONZALEZ<br>DISTRICT H | ROBERT GALLEGOS<br>DISTRICT I |
| MIKE LASTER<br>DISTRICT J       | LARRY GREEN<br>DISTRICT K |                               |

#### COUNCIL MEMBERS AT-LARGE

|                                   |                                    |
|-----------------------------------|------------------------------------|
| STEPHEN C. COSTELLO<br>POSITION 1 | DAVID W. ROBINSON<br>POSITION 2    |
| MICHAEL KUBOSH<br>POSITION 3      | C.O. "BRAD" BRADFORD<br>POSITION 4 |
| JACK CHRISTIE<br>POSITION 5       |                                    |

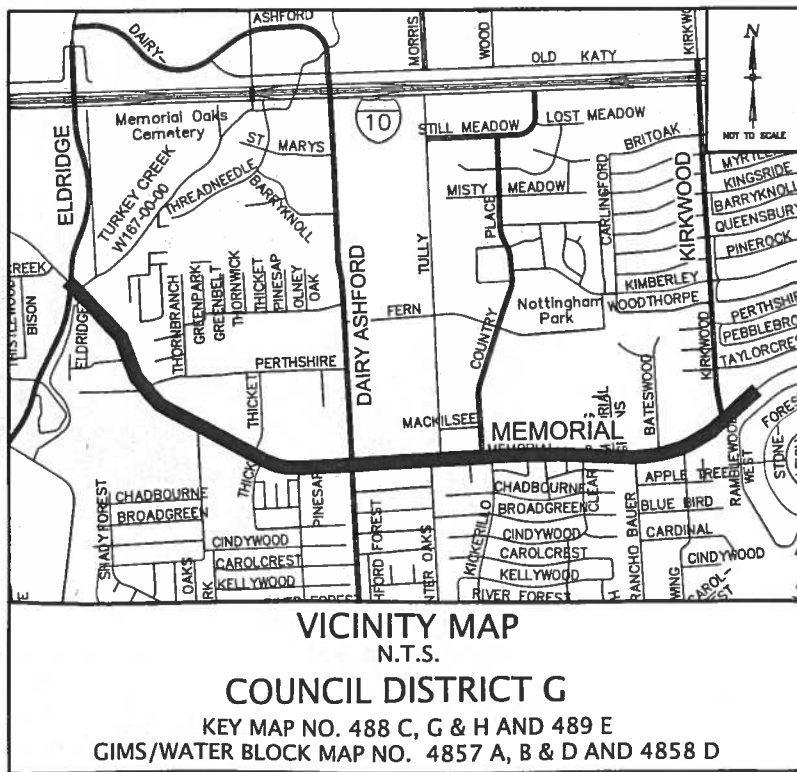
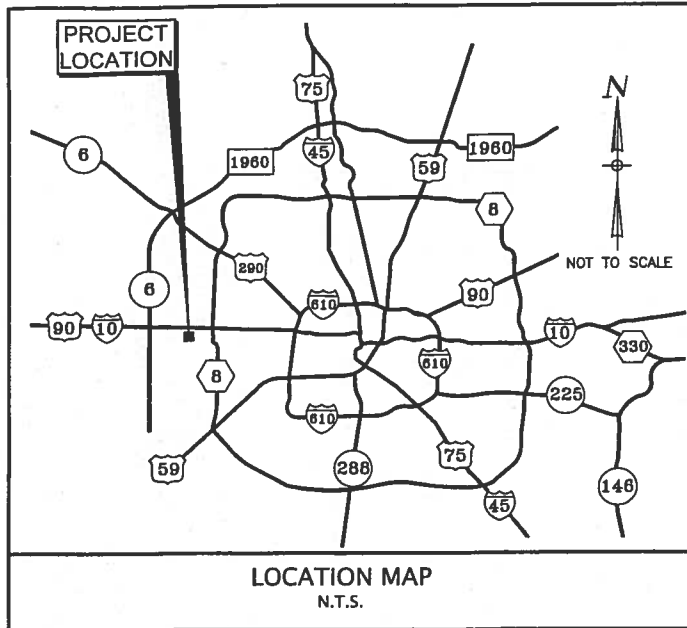

TDLR EABPRJB4812912



RECOMMENDED FOR LETTING

APPROVED FOR LETTING 2/24/15

Amir Yousefi 2/24/15  
PROJECT ENGINEER

William Standish, PE  
DISTRICT ENGINEER

**CivilTech Engineering, Inc.**

11821 Telge Road  
Cypress, Texas 77429  
(281) 304-0200 Fax (281) 304-0210  
Registration No. F-382

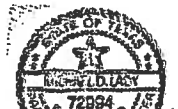

Michael J. Jay  
1/27/2015

SURVEYED BY: WESTERN GROUP CONSULTANTS  
FB NO. P-5779

[Signature] 3/09/15  
WATER

[Signature] PE 3/2/15  
TRAFFIC AND TRANSPORTATION

[Signature]  
WASTEWATER

[Signature] PE, PTOE  
SIGNALS 03/08/15

[Signature] 3/3/15  
STORM WATER

[Signature] 3/9/15  
MANAGING ENGINEER/ASSISTANT DIRECTOR

[Signature] 3/6/15  
STREET & BRIDGE

[Signature] 3-5-15  
PARK-FORESTRY DEPT

[Signature] 3/5/15  
CONSTRUCTION

N/A  
SPONSOR DIV / DEPT

[Signature] 3/22/15  
CITY ENGINEER DATE

[Signature] 4/6/15  
DIRECTOR OF PUBLIC WORKS AND ENGINEERING DATE



SHEET NO 1 OF 358 SHEETS

I.L.M.S. NO:

LOG NO:

MEMORIAL DRIVE  
PAVING AND DRAINAGE  
IMPROVEMENTS PROJECT  
WBS No.N-000798-0001-4

CivilTech Engineering, Inc. 2009 280032 1/27/15

KIT Professionals, Inc.  
 M:\VTL\Projects\09\_PW\_119\_Memorial Drive\Drawings\09\_PMD-01.dwg Mar 10, 2015 10:12am lida

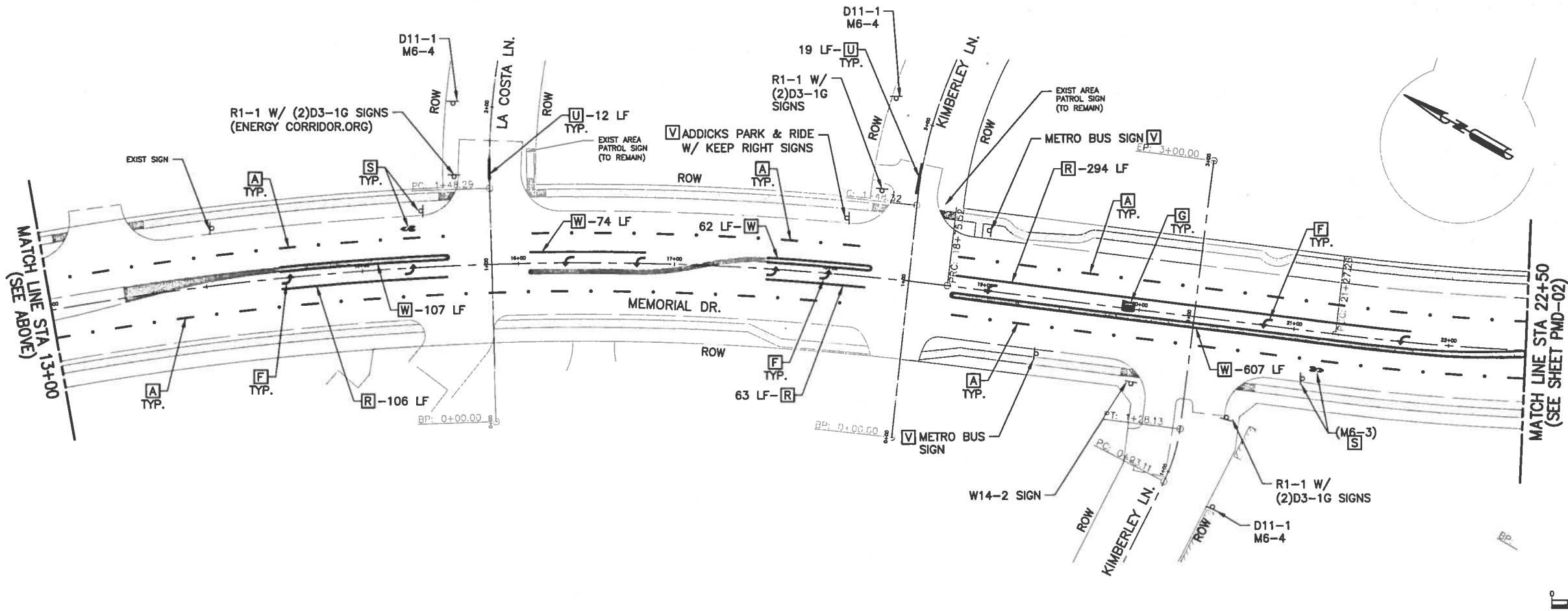
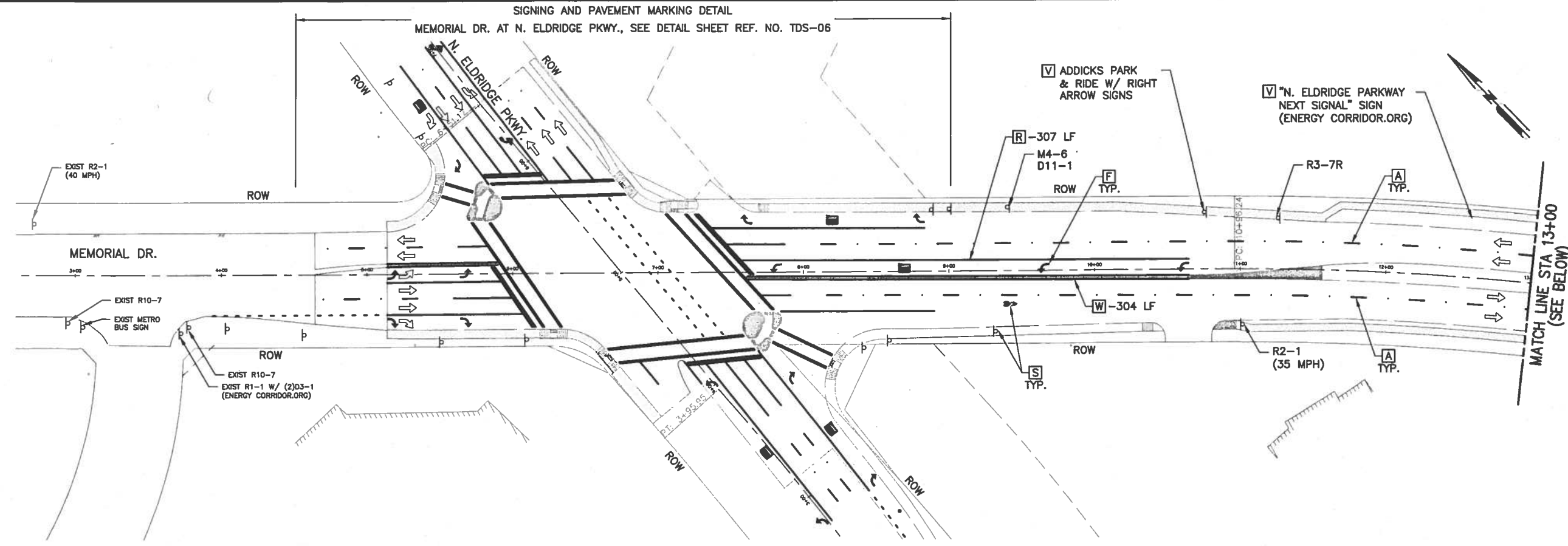

| REV | DESCRIPTION | BY | DATE |
|-----|-------------|----|------|
|     |             |    |      |

- LEGEND**
- [A] WB4-R40
  - [B] WS4
  - [C] WS6-R20
  - [D] WS12
  - [E] WS24
  - [F] PAV MARK-ARROW
  - [G] PAV MARK "ONLY" WORD
  - [H] TY1 C-R MARKER
  - [J] YDS4-A40/A40
  - [K] TY1 A-A MARKER
  - [L] PAV MARK WHITE MEDIAN CURB
  - [M] PAV MARK YELLOW MEDIAN CURB
  - [N] WB4-C40
  - [O] WG6
  - [P] WS6-C20
  - [Q] YDS4-A20/A20
  - [R] WS6
  - [S] BICYCLE WITH ARROW, SEE COH STND DTL DWG# 01510-09
  - [T] TY1 C MARKER
  - [U] YDS4
  - [V] CONTRACTOR TO INSTALL SIGNS FURNISHED BY OTHERS
  - [W] PAV MARK YELLOW 2' MEDIAN
  - [A] PROPOSED POLE DESIGNATION
  - [ ] PROPOSED DETECTABLE WARNING
  - ⊥ PROPOSED SIGN ON POST
  - ↔ TRAFFIC FLOW



**CivilTech Engineering, Inc.**

11821 Telge Road  
 Cypress, Texas 77429  
 (281) 304-0200 Fax (281) 304-0210  
 Registration No. F-382



SURVEYED BY: WGC FB No. P-5779

**CITY OF HOUSTON**  
 DEPARTMENT OF PUBLIC WORKS AND ENGINEERING

**MEMORIAL DRIVE**  
 PAVING AND DRAINAGE IMPROVEMENTS  
 SIGNING AND PAVEMENT MARKING LAYOUT

|                      |                       |
|----------------------|-----------------------|
| PMD-01               |                       |
| WBS NUMBER           | N-000798-0001-4       |
| DRAWING SCALE        | 1"=40'                |
| CITY OF HOUSTON PM   | MICHELLE RANDON, P.E. |
| SHEET No. 309 OF 358 | 53954                 |

| REV | DESCRIPTION | BY | DATE |
|-----|-------------|----|------|
|     |             |    |      |

**LEGEND**

- [A] WB4-R40
- [B] WS4
- [C] WS6-R20
- [D] WS12
- [E] WS24
- [F] PAV MARK-ARROW
- [G] PAV MARK "ONLY" WORD
- [H] TYII C-R MARKER
- [J] YDS4-A40/A40
- [K] TYII A-A MARKER
- [L] PAV MARK WHITE MEDIAN CURB
- [M] PAV MARK YELLOW MEDIAN CURB
- [N] WB4-C40
- [P] WS6-C20
- [Q] YDS4-A20/A20
- [R] WS6
- [S] BICYCLE WITH ARROW, SEE COH STND DTL DWG# 01510-09
- [T] TYI C MARKER
- [U] YDS4
- [V] CONTRACTOR TO INSTALL SIGNS FURNISHED BY OTHERS
- [W] PAV MARK YELLOW 2' MEDIAN
- [A] PROPOSED POLE DESIGNATION
- [ ] PROPOSED DETECTABLE WARNING
- [ ] PROPOSED SIGN ON POST
- [ ] TRAFFIC FLOW

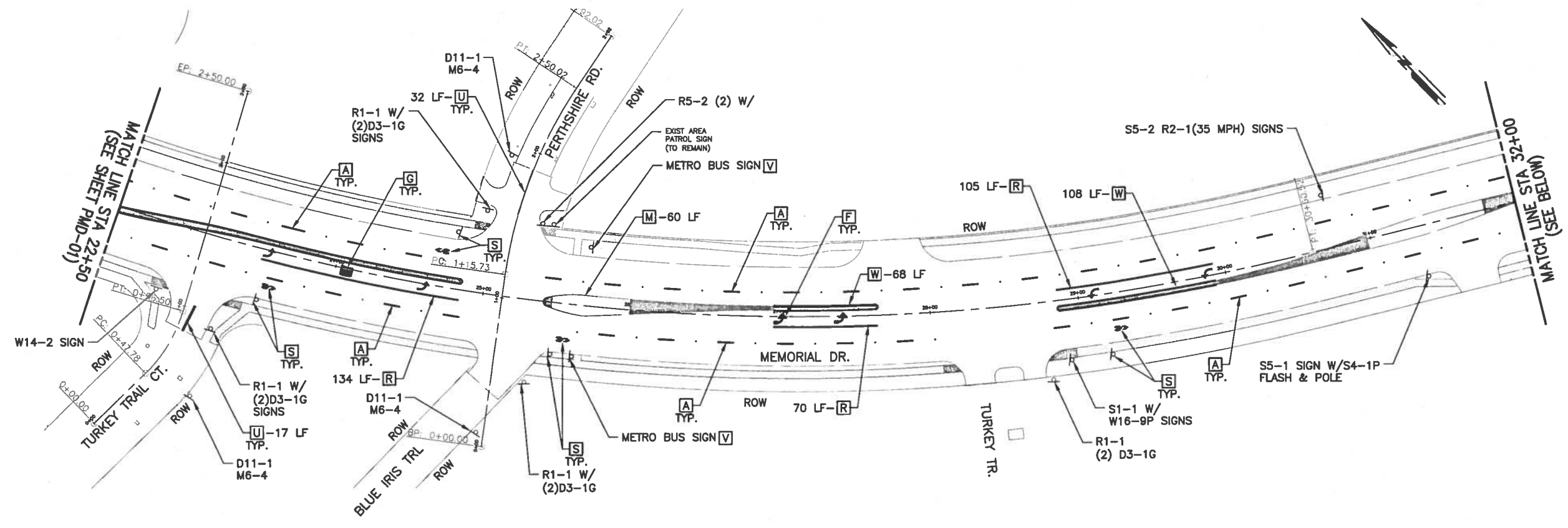

**SIGNING AND PAVEMENT MARKING DETAIL**  
MEMORIAL DR. AT NOTTINGHAM OAKS TR., SEE DETAILS SHEET REF. NO. TDS-13

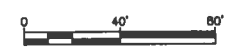
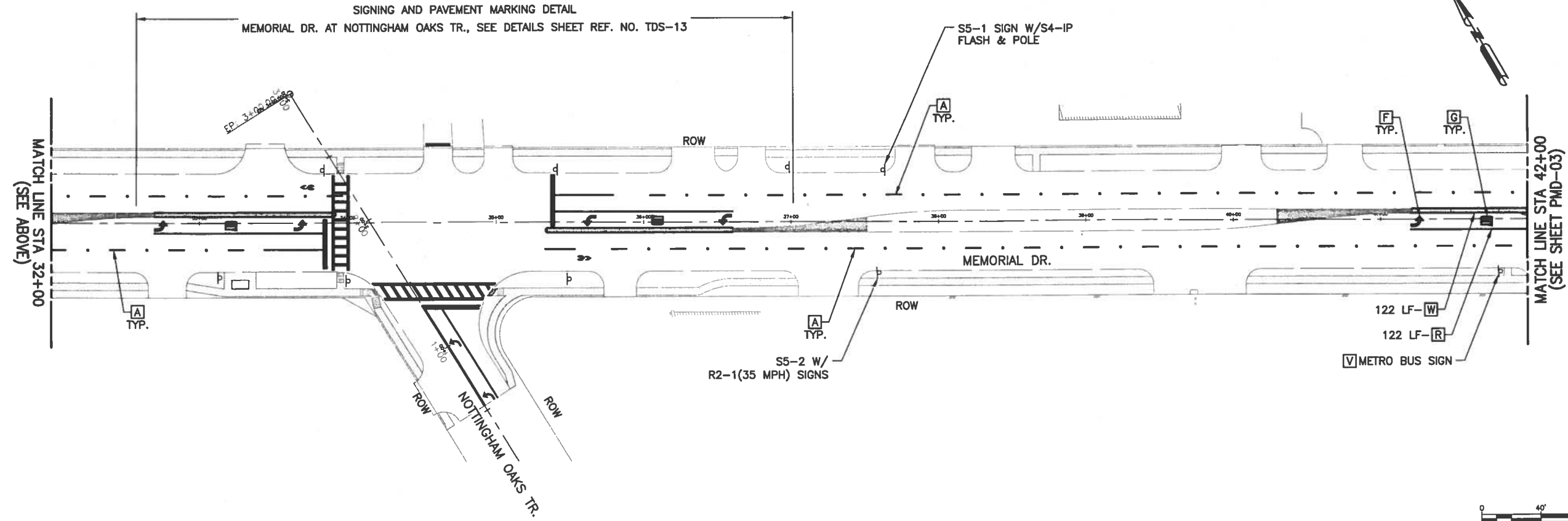

**CivilTech Engineering, Inc.**

11821 Telge Road  
Cypress, Texas 77429  
(281) 304-0200 Fax (281) 304-0210  
Registration No. F-382

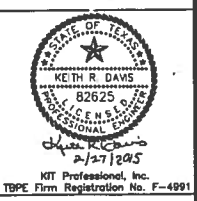

SURVEYED BY: WGC FB No. P-5779

**CITY OF HOUSTON**  
DEPARTMENT OF PUBLIC WORKS AND ENGINEERING

**MEMORIAL DRIVE**  
PAVING AND DRAINAGE IMPROVEMENTS  
SIGNING AND PAVEMENT MARKING LAYOUT

PMD-02

|                      |                       |
|----------------------|-----------------------|
| WBS NUMBER           | N-000798-0001-4       |
| DRAWING SCALE        | 1"=40'                |
| CITY OF HOUSTON PM   | MICHELLE RANDON, P.E. |
| SHEET No. 310 OF 358 |                       |



KIT Professionals, Inc. M:\VPL Projects\908\_PMD-02\119 Memorial Drive\PROJ\3.2 CAD\3.2.4 TDP Pavement Marking\PM-02.dwg Mar 10, 2015 10:42am lot#

| REV | DESCRIPTION | BY | DATE |
|-----|-------------|----|------|
|     |             |    |      |

**LEGEND**

- A WB4-R40
- B WS4
- C WS6-R20
- D WS12
- E WS24
- F PAV MARK-ARROW
- G PAV MARK "ONLY" WORD
- H TYII C-R MARKER
- J YDS4-A40/A40
- K TYII A-A MARKER
- L PAV MARK WHITE MEDIAN CURB
- M PAV MARK YELLOW MEDIAN CURB
- N WB4-C40
- P WS6-C20
- Q YDS4-A20/A20
- R WS6
- S BICYCLE WITH ARROW, SEE COH STND DTL DWG# 01510-09
- T TYI C MARKER
- U YDS4
- V CONTRACTOR TO INSTALL SIGNS FURNISHED BY OTHERS
- W PAV MARK YELLOW 2' MEDIAN
- A PROPOSED POLE DESIGNATION
- PROPOSED DETECTABLE WARNING
- PROPOSED SIGN ON POST
- TRAFFIC FLOW

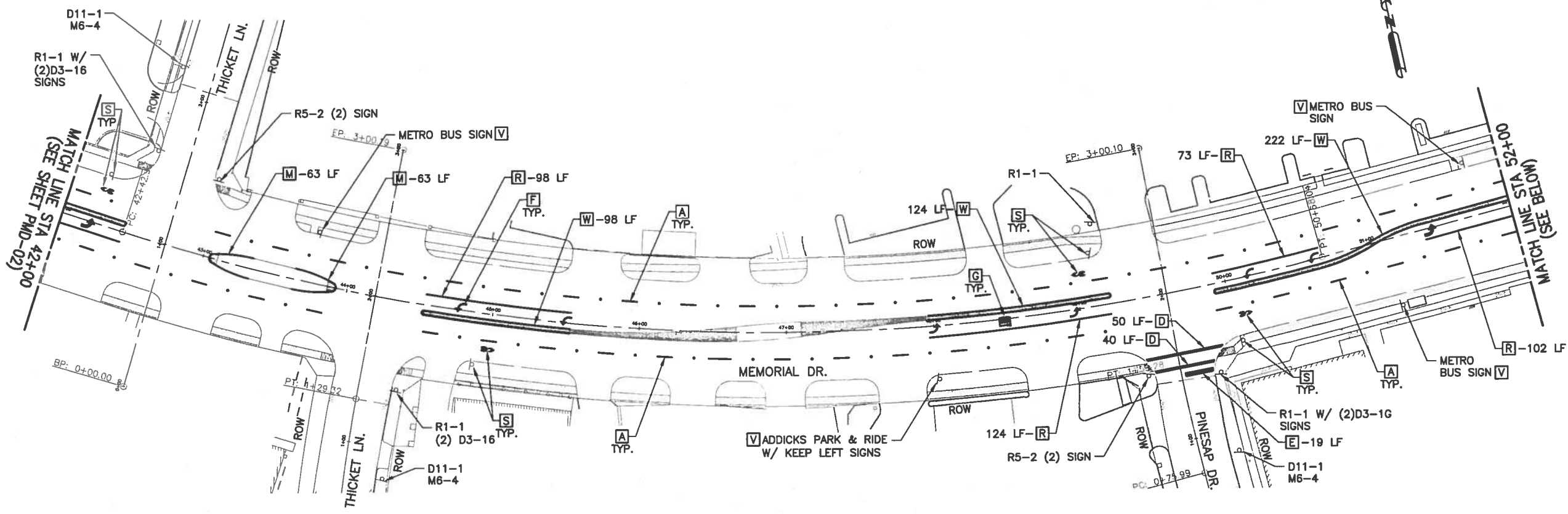

**SIGNING AND PAVEMENT MARKING DETAIL  
MEMORIAL DR. AT DAIRY ASHFORD DR., SEE DETAILS SHEET REF. NO. TDS-19**

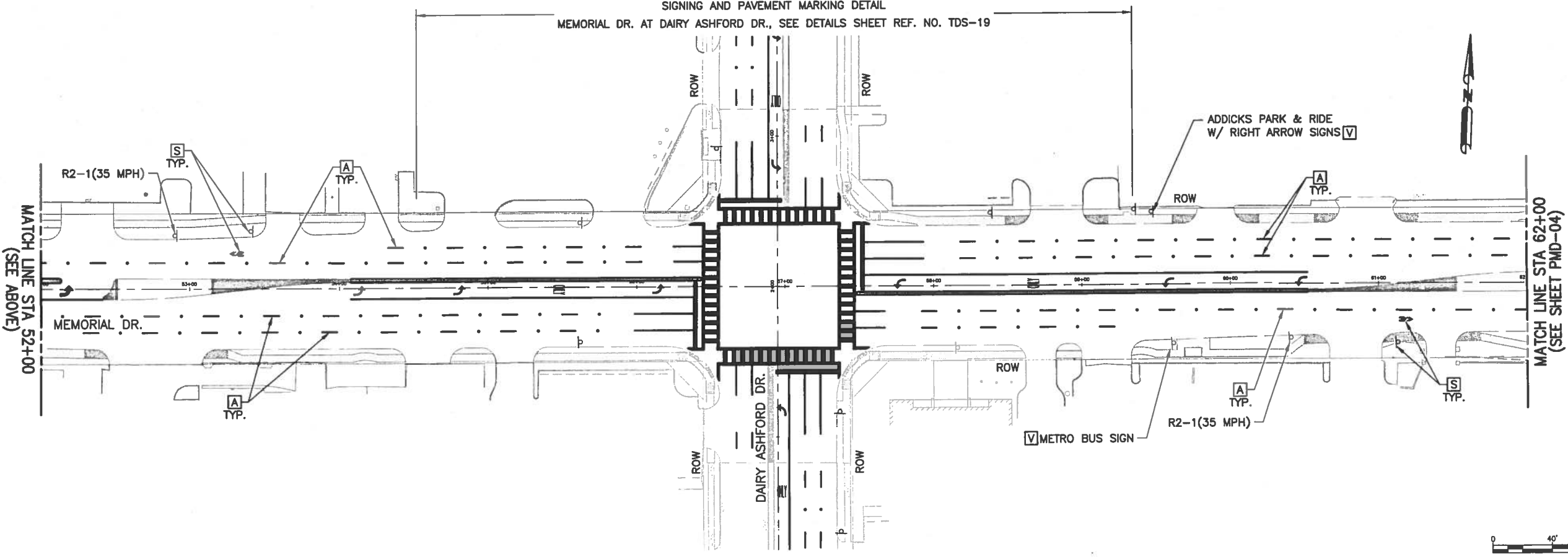

**CivilTech  
Engineering, Inc.**

11821 Telge Road  
Cypress, Texas 77429  
(281) 304-0200 Fax (281) 304-0210  
Registration No. F-382

**KIT Professionals, Inc.**  
Engineers • Planners • Construction Managers  
2000 S. Sam Houston Parkway S, Suite 1400  
Houston, Texas 77042  
Phone: (713) 783-8700, Fax: (713) 783-8747  
TBPCE Firm Registration No. F-4991

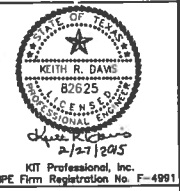

SURVEYED BY: WGC FB No. P-5779

**CITY OF HOUSTON**  
DEPARTMENT OF PUBLIC WORKS AND ENGINEERING

**MEMORIAL DRIVE**  
PAVING AND DRAINAGE IMPROVEMENTS  
SIGNING AND PAVEMENT  
MARKING LAYOUT

PMD-03

|                    |                       |
|--------------------|-----------------------|
| WBS NUMBER         | N-000798-0001-4       |
| DRAWING SCALE      | 1"=40'                |
| CITY OF HOUSTON PM | MICHELLE RANDON, P.E. |
| SHEET No.          | 311 OF 358            |



KIT Professionals, Inc. J:\VCI\_Projects\09\_PMD-03\_Memorial Drive\03\_2.4\_TPO\Plan\Pavement\_Marking\PM-03.dwg Mar 10, 2015 10:52am. Note

| REV | DESCRIPTION | BY | DATE |
|-----|-------------|----|------|
|     |             |    |      |

SIGNING AND PAVEMENT MARKING DETAIL  
MEMORIAL DR. AT TULLY ST., SEE DETAILS SHEET REF. NO. TDS-25

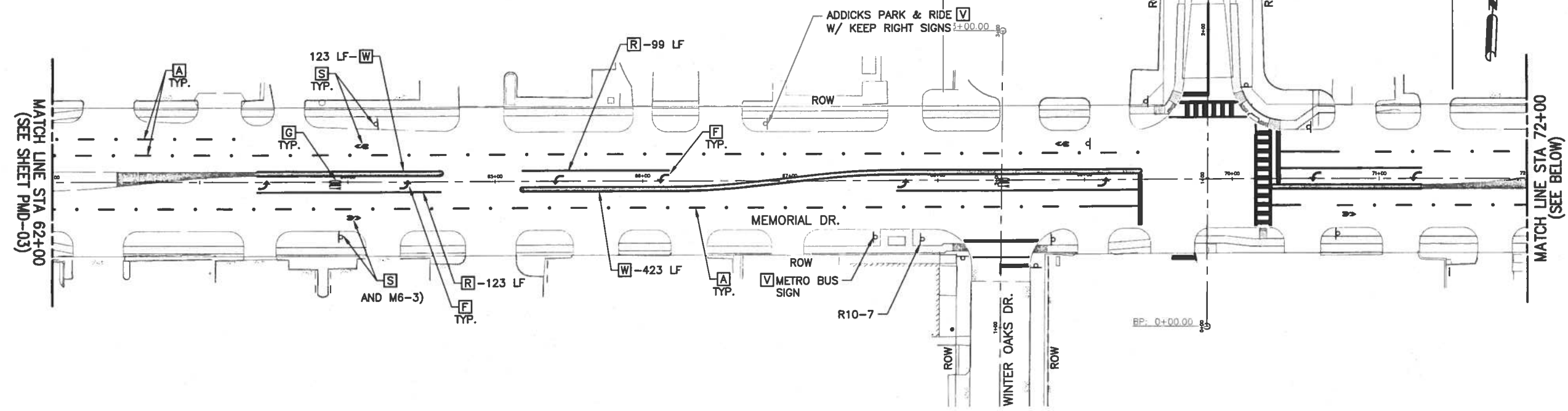

- LEGEND**
- [A] WB4-R40
  - [B] WS4
  - [C] WS6-R20
  - [D] WS12
  - [E] WS24
  - [F] PAV MARK-ARROW
  - [G] PAV MARK "ONLY" WORD
  - [H] TY11 C-R MARKER
  - [J] YDS4-A40/A40
  - [K] TY11 A-A MARKER
  - [L] PAV MARK WHITE MEDIAN CURB
  - [M] PAV MARK YELLOW MEDIAN CURB
  - [N] WB4-C40
  - [P] WS6-C20
  - [Q] YDS4-A20/A20
  - [R] WS6
  - [S] BICYCLE WITH ARROW, SEE COH STND DTL DWG# 01510-09
  - [T] TY1 C MARKER
  - [U] YDS4
  - [V] CONTRACTOR TO INSTALL SIGNS FURNISHED BY OTHERS
  - [W] PAV MARK YELLOW 2' MEDIAN
  - [A] PROPOSED POLE DESIGNATION
  - [S] PROPOSED DETECTABLE WARNING
  - [P] PROPOSED SIGN ON POST
  - [T] TRAFFIC FLOW



**CivilTech Engineering, Inc.**

11821 Telge Road  
Cypress, Texas 77429  
(281) 304-0200 Fax (281) 304-0210  
Registration No. F-382



**CITY OF HOUSTON**  
DEPARTMENT OF PUBLIC WORKS AND ENGINEERING

MEMORIAL DRIVE  
PAVING AND DRAINAGE IMPROVEMENTS

SIGNING AND PAVEMENT MARKING LAYOUT

PMD-04

WBS NUMBER  
N-000798-0001-4

DRAWING SCALE  
1"=40'

CITY OF HOUSTON PM  
MICHELLE RANDON, P.E.

SHEET No. 312 OF 358

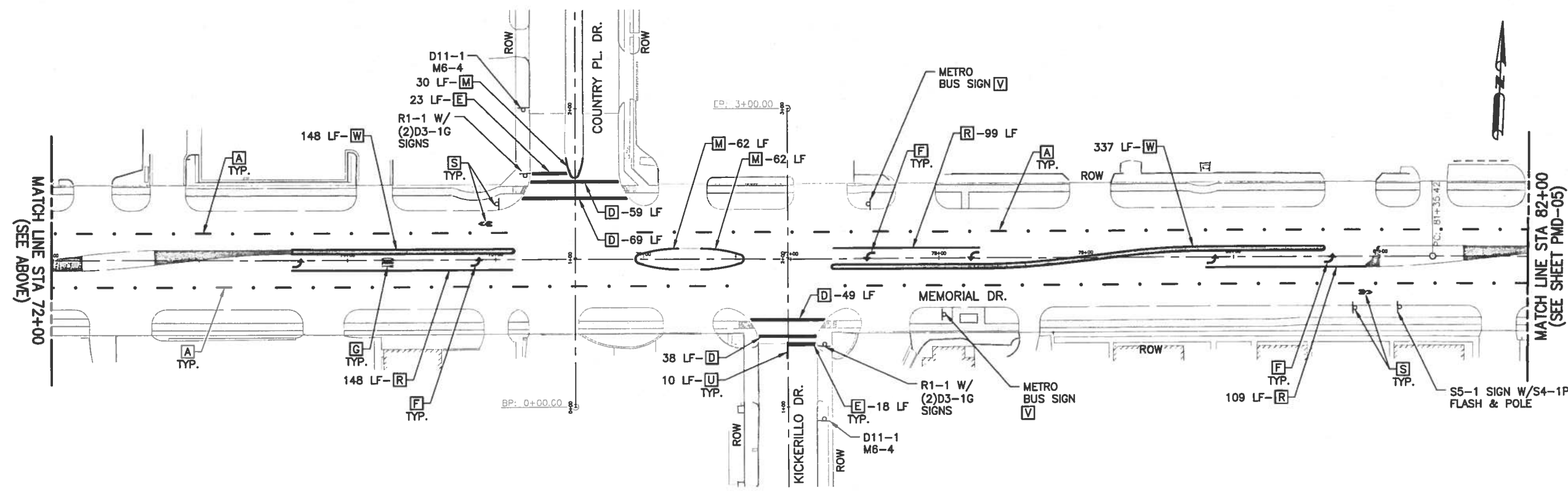

SURVEYED BY: WGC FB No. P-5779

STATE OF TEXAS  
KEITH R. DAVIS  
REGISTERED PROFESSIONAL ENGINEER  
No. 82625  
2/27/2015  
KIT Professionals, Inc.  
TBPPE Firm Registration No. F-4991

WBS NUMBER  
N-000798-0001-4

DRAWING SCALE  
1"=40'

CITY OF HOUSTON PM  
MICHELLE RANDON, P.E.

SHEET No. 312 OF 358

53954



| REV | DESCRIPTION | BY | DATE |
|-----|-------------|----|------|
|     |             |    |      |

SIGNING AND PAVEMENT MARKING DETAIL  
MEMORIAL DR. AT CLEAR SPRINGS DR., SEE DETAILS SHEET REF. NO. TDS-31

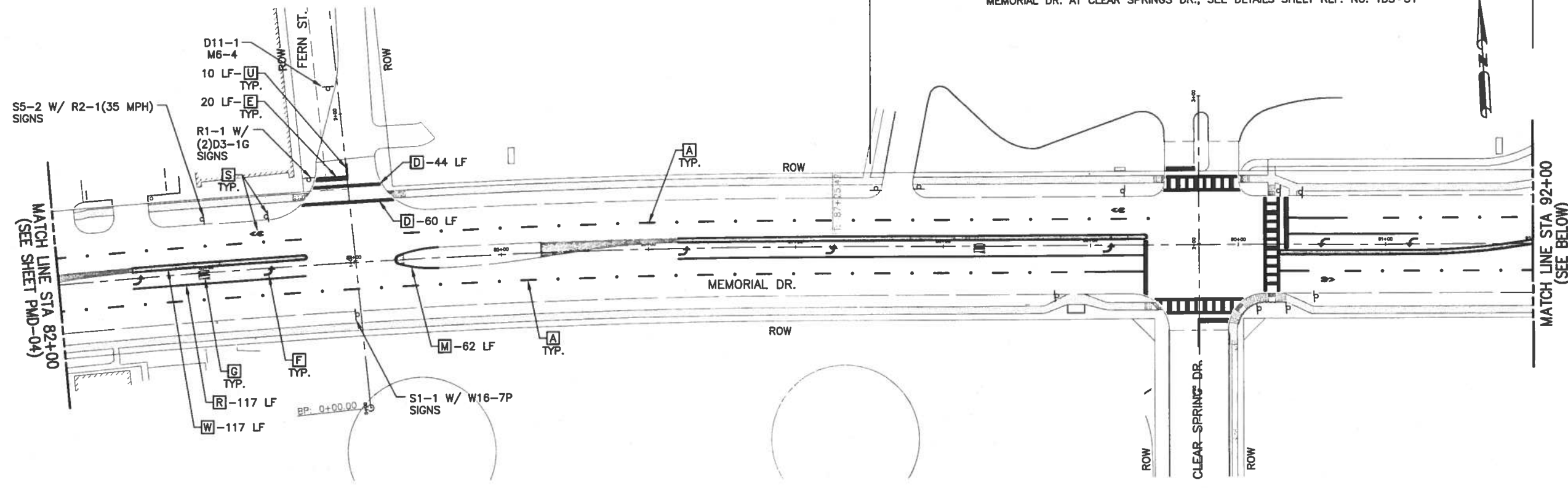

- LEGEND**
- [A] WB4-R40
  - [B] WS4
  - [C] WS6-R20
  - [D] WS12
  - [E] WS24
  - [F] PAV MARK-ARROW
  - [G] PAV MARK "ONLY" WORD
  - [H] TY11 C-R MARKER
  - [J] YDS4-A40/A40
  - [K] TY11 A-A MARKER
  - [L] PAV MARK WHITE MEDIAN CURB
  - [M] PAV MARK YELLOW MEDIAN CURB
  - [N] WB4-C40
  - [P] WS6-C20
  - [Q] YDS4-A20/A20
  - [R] WS6
  - [S] BICYCLE WITH ARROW, SEE COH STND DTL DWG# 01510-09
  - [T] TY1 C MARKER
  - [U] YDS4
  - [V] CONTRACTOR TO INSTALL SIGNS FURNISHED BY OTHERS
  - [W] PAV MARK YELLOW 2' MEDIAN
  - [A] PROPOSED POLE DESIGNATION
  - [Hatched Box] PROPOSED DETECTABLE WARNING
  - [T on Post] PROPOSED SIGN ON POST
  - [Arrow] TRAFFIC FLOW



SIGNING AND PAVEMENT MARKING DETAIL  
MEMORIAL DR. AT BATESWOOD DR., SEE DETAILS SHEET REF. NO. TDS-37

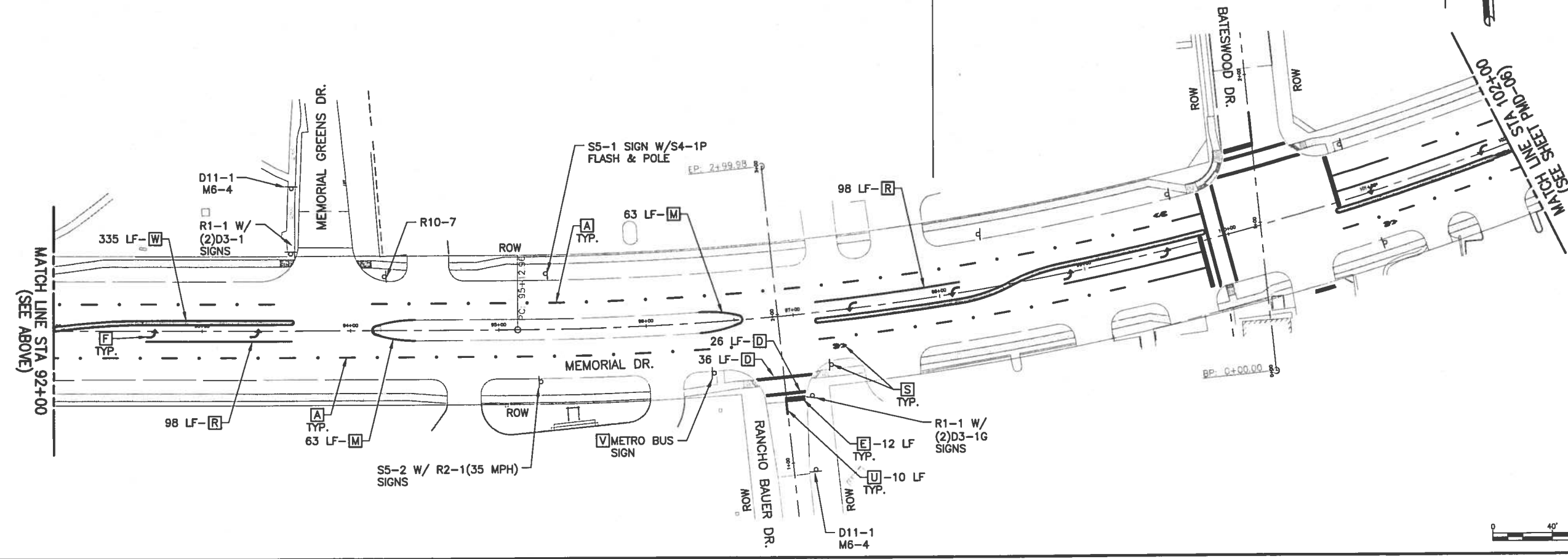

**CivilTech Engineering, Inc.**  
11821 Telge Road  
Cypress, Texas 77429  
(281) 304-0200 Fax (281) 304-0210  
Registration No. F-382

**KIT Professionals, Inc.**  
Engineers • Planners • Construction Managers  
2000 S. Sam Houston Parkway S, Suite 1400  
Houston, Texas 77052  
Phone: (713) 783-8700; Fax: (713) 783-8747  
TSPCE Firm Registration No. F-4991

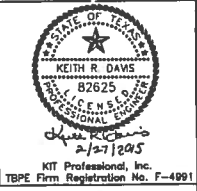

SURVEYED BY: WGC FB No. P-5779

**CITY OF HOUSTON**  
DEPARTMENT OF PUBLIC WORKS AND ENGINEERING  
MEMORIAL DRIVE  
PAVING AND DRAINAGE IMPROVEMENTS  
SIGNING AND PAVEMENT MARKING LAYOUT

|                      |                       |
|----------------------|-----------------------|
| WBS NUMBER           | N-000798-0001-4       |
| DRAWING SCALE        | 1"=40'                |
| CITY OF HOUSTON PM   | MICHELLE RANDON, P.E. |
| SHEET No. 313 OF 358 |                       |



KIT Professionals, Inc.  
H:\KIT\_Projects\109\_PMD-110\_Memorial Drive\Road\1.2\_CAD\1.2.4\_TSP\Plan\Signing and Pavement Marking\109-PMD-05.dwg Mar 10, 2015 10:33am 014

| REV | DESCRIPTION | BY | DATE |
|-----|-------------|----|------|
|     |             |    |      |
|     |             |    |      |

SIGNING AND PAVEMENT MARKING DETAIL  
MEMORIAL DR. AT N. KIRKWOOD RD., SEE DETAILS SHEET REF. NO. TDS-42

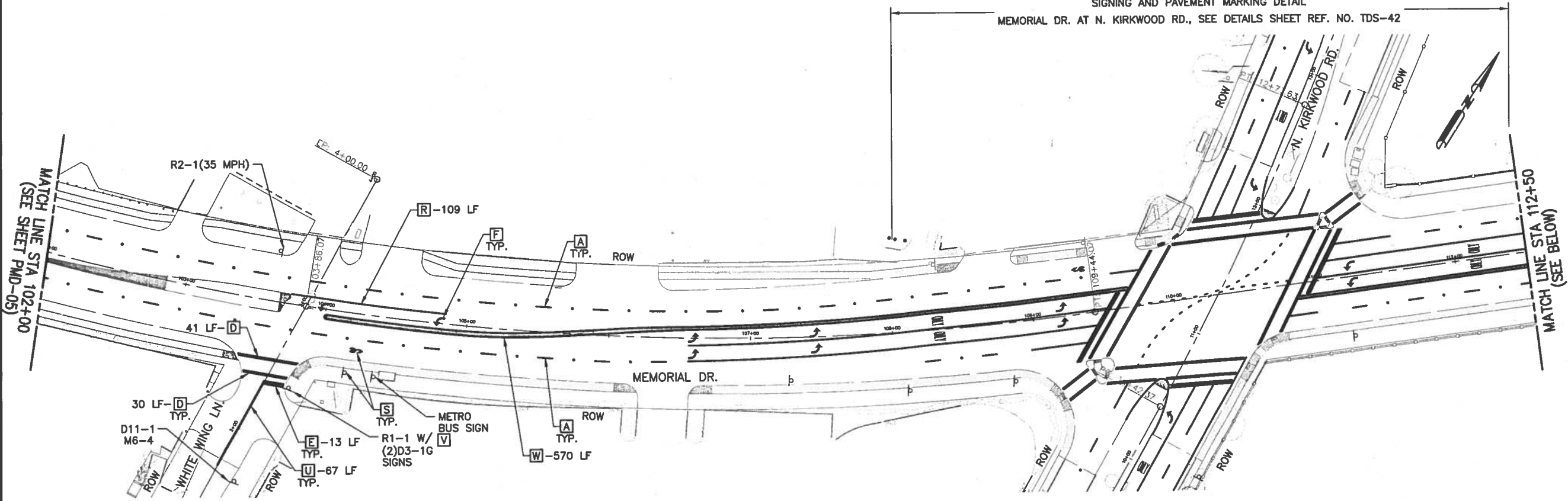

- LEGEND**
- A WB4-R40
  - B WS4
  - C WS6-R20
  - D WS12
  - E WS24
  - F PAV MARK-ARROW
  - G PAV MARK "ONLY" WORD
  - H TYI C-R MARKER
  - J YDS4-A40/A40
  - K TYI A-A MARKER
  - L PAV MARK WHITE MEDIAN CURB
  - M PAV MARK YELLOW MEDIAN CURB
  - N WB4-C40
  - P WS6-C20
  - Q YDS4-A20/A20
  - R WS6
  - S BICYCLE WITH ARROW, SEE COH STND DTL DWG# 01510-09
  - T TYI C MARKER
  - U YDS4
  - V CONTRACTOR TO INSTALL SIGNS FURNISHED BY OTHERS
  - W PAV MARK YELLOW 2' MEDIAN
  - X PROPOSED POLE DESIGNATION
  - Y PROPOSED DETECTABLE WARNING
  - Z PROPOSED SIGN ON POST
  - ← TRAFFIC FLOW

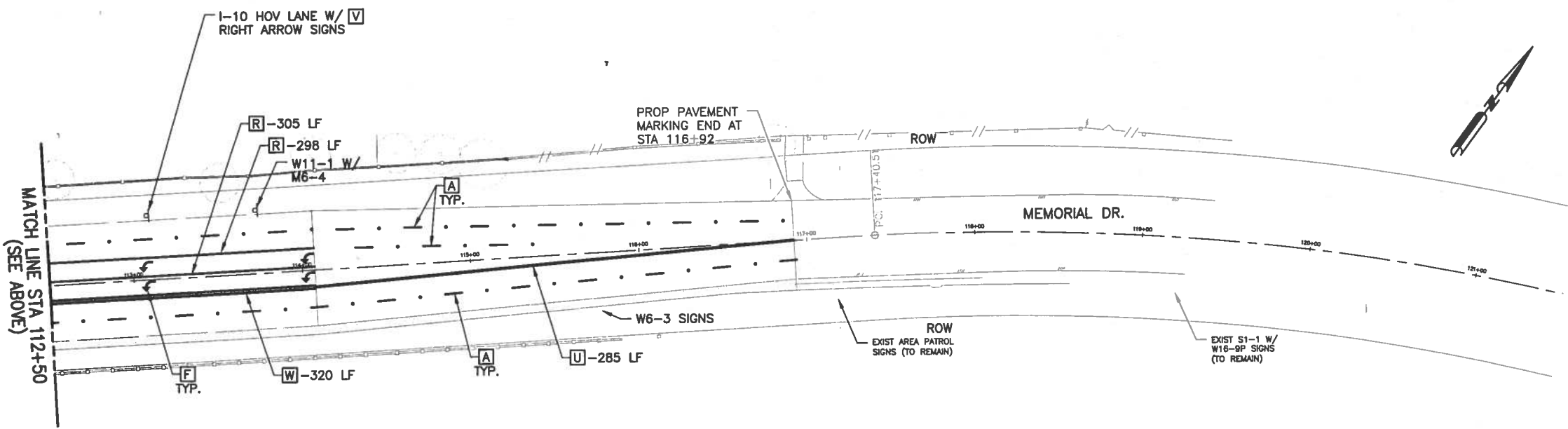

**CivilTech Engineering, Inc.**

11821 Teige Road  
Cypress, Texas 77429  
(281) 304-0200 Fax (281) 304-0210  
Registration No. F-382

**KIT Professionals, Inc.**  
Engineers • Planners • Construction Managers  
3000 S. Sam Houston Parkway S., Suite 1400  
Houston, Texas 77042  
Phone (713) 783-8700; Fax (713) 783-8747  
TBPE Firm Registration No. F-4991



SURVEYED BY: WGC FB No. P-5779

**CITY OF HOUSTON**  
DEPARTMENT OF PUBLIC WORKS AND ENGINEERING

**MEMORIAL DRIVE**  
PAVING AND DRAINAGE IMPROVEMENTS  
SIGNING AND PAVEMENT MARKING LAYOUT

PMD-06

|                    |                       |
|--------------------|-----------------------|
| WBS NUMBER         | N-000798-0001-4       |
| DRAWING SCALE      | 1"=40'                |
| CITY OF HOUSTON PM | MICHELLE RANDON, P.E. |
| SHEET No.          | 314 OF 358            |

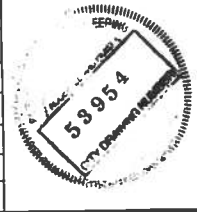

KIT Professionals, Inc.  
M:\VTL\_Projects\09\_PMD-06\115 Memorial Drive\PM03\3.2.dwg (Paved) 10-Mar-10 10:15:10 User: tate