

**CERTIFICATE OF APPROPRIATENESS**

**Applicant:** Shannon Walker, owner

**Property:** Lots 14, 15 & E Part Lots 16 & 17 Block 3 of Columbus, Lots 1-4, S/E 50', Block 2 of Macdonald, and 4.6'x81.60' of Large Lot 43, City of Houston, Harris County, Texas. The site includes a one-story, brick commercial structure with an attached one-story side show room, and a two-story garage addition on a 24,924 square foot lot.

**Significance:** The Quality Laundry Building is a City of Houston Protected Landmark designated in June 2018. The Art Deco-style one-story historic commercial structure was constructed circa 1932. The building was altered in the 1960s including encasing the building and removing part of the deco fan detail over the front entrance.

**Proposal:** Alteration- Sign

The applicant is proposing to install a 15'-4" x 3'-10" reverse channel letter LED illuminated sign.

- 3" sidewalls .063 aluminum painted gold
- Back: .15" clear polycarbonate
- Illumination: 12V White LED's
- Face: .125" aluminum painted gold
- Mounting: Individually to the sign face with 2.5" standoffs using 3/8"
- Power Supply: LED low vltg

**Public Comment:** No public comment received

**Civic Association:**

**Recommendation:** Approval

**HAHC Action:**

## ALTERATIONS, REHABILITATIONS, RESTORATIONS AND ADDITIONS

Sec. 33-241: HAHC shall issue a certificate of appropriateness for the alteration, rehabilitation, restoration or addition of an exterior feature of (i) any landmark, (ii) protected landmark, (iii) any building, structure or object that is part of an archaeological site, or (iv) contributing building in a historic district upon finding that the application satisfies the following criteria, as applicable:

- | <b>S</b>                            | <b>D</b>                 | <b>NA</b>                | <b>S - satisfies</b> | <b>D - does not satisfy</b>   | <b>NA - not applicable</b> |
|-------------------------------------|--------------------------|--------------------------|----------------------|---|----------------------------|
| <input checked="" type="checkbox"/> | <input type="checkbox"/> | <input type="checkbox"/> | (1)                  | The proposed activity must retain and preserve the historical character of the property;  |                            |
| <input checked="" type="checkbox"/> | <input type="checkbox"/> | <input type="checkbox"/> | (2)                  | The proposed activity must contribute to the continued availability of the property for a contemporary use;   |                            |
| <input checked="" type="checkbox"/> | <input type="checkbox"/> | <input type="checkbox"/> | (3)                  | The proposed activity must recognize the building, structure, object or site as a product of its own time and avoid alterations that seek to create an earlier or later appearance;   |                            |
| <input checked="" type="checkbox"/> | <input type="checkbox"/> | <input type="checkbox"/> | (4)                  | The proposed activity must preserve the distinguishing qualities or character of the building, structure, object or site and its environment;   |                            |
| <input checked="" type="checkbox"/> | <input type="checkbox"/> | <input type="checkbox"/> | (5)                  | The proposed activity must maintain or replicate distinctive stylistic exterior features or examples of skilled craftsmanship that characterize the building, structure, object or site;  |                            |
| <input checked="" type="checkbox"/> | <input type="checkbox"/> | <input type="checkbox"/> | (6)                  | New materials to be used for any exterior feature excluding what is visible from public alleys must be visually compatible with, but not necessarily the same as, the materials being replaced in form, design, texture, dimension and scale;   |                            |
| <input checked="" type="checkbox"/> | <input type="checkbox"/> | <input type="checkbox"/> | (7)                  | The proposed replacement of exterior features, if any, should be based on an accurate duplication of features, substantiated by available historical, physical or pictorial evidence, where that evidence is available, rather than on conjectural designs or the availability of different architectural elements from other structures; |                            |
| <input checked="" type="checkbox"/> | <input type="checkbox"/> | <input type="checkbox"/> | (8)                  | Proposed additions or alterations must be done in a manner that, if removed in the future, would leave unimpaired the essential form and integrity of the building, structure, object or site;  |                            |
| <input checked="" type="checkbox"/> | <input type="checkbox"/> | <input type="checkbox"/> | (9)                  | The proposed design for any exterior alterations or addition must not destroy significant historical, architectural, archaeological or cultural material, including but not limited to siding, windows, doors and porch elements;   |                            |
| <input checked="" type="checkbox"/> | <input type="checkbox"/> | <input type="checkbox"/> | (10)                 | The proposed alteration or addition must be compatible with the massing, size, scale material and character of the property and the context area; and   |                            |
| <input checked="" type="checkbox"/> | <input type="checkbox"/> | <input type="checkbox"/> | (11)                 | The distance from the property line to the front and side walls, porches, and exterior features of any proposed addition or alteration must be compatible with the distance to the property line of similar elements of existing contributing structures in the context area.   |                            |



**PROPERTY LOCATION**

**THE QUALITY LAUNDRY BUILDING LANDMARK**

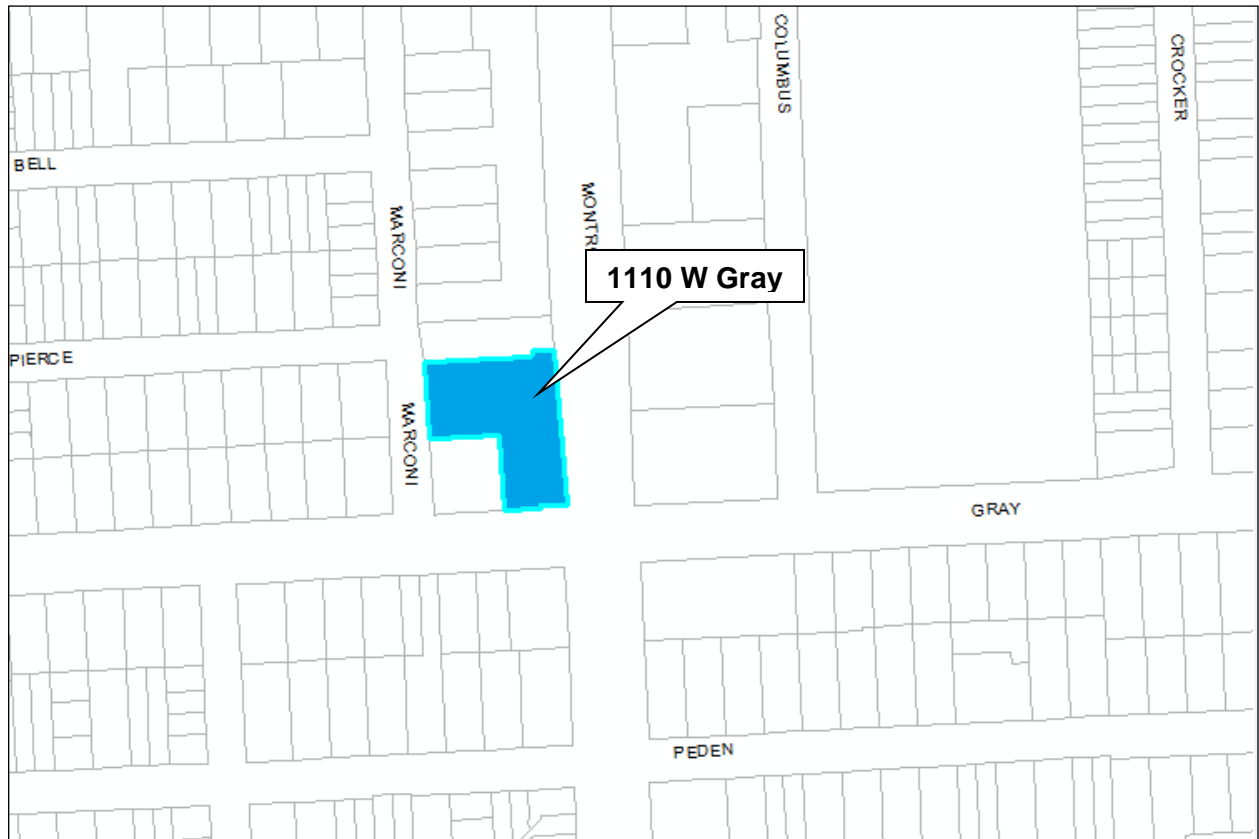

DRAFT

HISTORIC PHOTO C.1936



CURRENT PHOTO **\*\*SUBJECT TO CHANGE WITH MORE UP TO DATE PHOTO IF APPLICABLE**



AERIAL VIEW OF PROPERTY



### SITE PLAN

 EXISTING SIGNAGE

 PROPOSED SIGNAGE

3 of



### EXISTING ELEVATION



PROPOSED ELEVATION



SIGN DETAILS

A

Store front sign:

Fabrication and install of a set of LED illuminated reverse channel letters



FRONT ELEVATION  
SCALE PROPORTIONALLY

ELECTRICAL LOADS: VOLT : 120 AMP: 4.5

- 1 WALLS: 3" SIDEWALLS .063 ALUMINUM PAINTED GOLD
- 2 BACK: 0.15" CLEAR POLYCARBONATE
- 3 ILLUMINATION: 12V WHITE LEDS
- 4 FACE: 0.125" ALUMINUM PAINTED GOLD
- 5 MOUNTED: INDIVIDUALLY TO THE SIGN FACE WITH 2.5" STANDOFFS USING 3/8" X 18" FASTENERS PER CODE
- 6 POWER SUPPLY: LED LOW VLTG

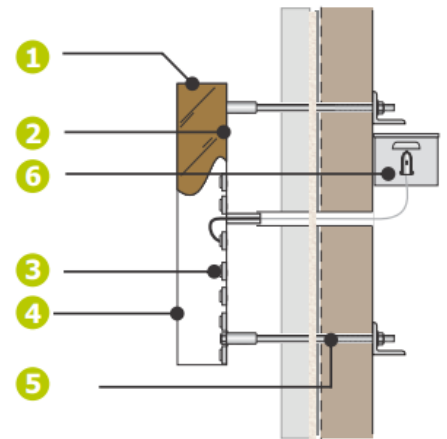

SECTION VIEW  
NOT TO SCALE

SPECIFICATION: ILLUMINATED REVERSE CHANNEL LETTERS

PROPOSED SIGNAGE  
SCALE PROPORTIONALLY

